

**1** **KOOLANCE** CNT-RP452X2R Installation (RP-402X2, RP-452X2) v1.0



When using the upper reservoir inlet/outlet (corresponding with Pump #2), an optional bleed pipe is available to assist with air filtration. This component can be left in place during operation and reduces the difficulty of bleeding this reservoir for RP-402X2 and RP-452X2 products.

**Installation**

Unscrew the 7 front bezel hex screws.



Remove the front aluminum bezel and acrylic window. Try to leave both black rubber o-rings in their grooves around the reservoirs.

If the o-rings will not stay put, safely set them aside. O-rings typically have oil applied during assembly, which may still be present.

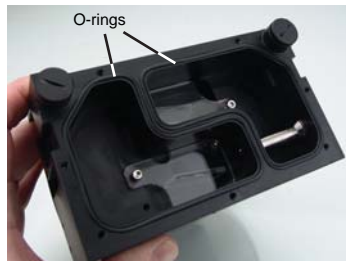

Remove the upper reservoir acrylic piece by unscrewing both hex nuts.

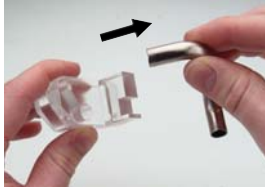

With the CNT-RP452X2R bleed pipe, separate the pipe from the acrylic piece. Make note of which end was connected. It should not be installed in reverse.

Insert the new CNT-RP452X2R acrylic piece into the upper reservoir and secure with the 2 original acrylic piece screws.



If you are changing the reservoir side plug, do this now before installing the bleed pipe. The pipe must be removed while changing the side plug.



The metal pipe can now be inserted into the acrylic piece. Once assembled, the front window will keep it in place. If the pipe does not fit, try inserting the other end.

If the original reservoir o-rings did not stay in place during installation, use the shorter o-rings included with the CNT-RP452X2R bleed pipe kit. Be careful to keep all o-rings clean and undamaged.



Apply oil to o-ring grooves with a cotton swab.



If original o-rings have come out, use the new ones.



Carefully push an o-ring into the groove around each reservoir.

Apply the included silicone oil with a cotton swab along the o-ring grooves surrounding both reservoirs. This will help keep the o-rings in place for assembly. Gently install each o-ring by guiding it into the groove. Try not to let the o-ring twist too much or it will be more difficult to keep in place.

Replace the front acrylic window, and check for any o-ring misalignment. Both o-rings must be safely within their grooves around each reservoir.



**4** **CAUTION:** O-ring gaskets which are dirty, damaged, or not situated within their designated grooves can cause the unit to leak. Confirm both o-rings look good before mounting the front aluminum bezel.



Replace the front aluminum bezel and hand-tighten the front hex nuts. **DO NOT OVER-TIGHTEN.**



Fill the upper reservoir while tipping this corner higher than the rest of the unit. This will allow more air to escape Pump 2's reservoir. Replace and tighten the fill port.

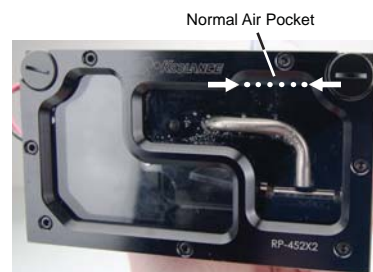

You do not need to remove all air from the reservoir. It is normal to have a small pocket in the top of the tank window.

Allow the pump to run for about 5-10 minutes so the reservoir can complete the bleeding process. As is normal, you may need to add more coolant and tip the entire cooling system during this process to assist with air filtration.