



Koolance's ALX series are powerful liquid cooling systems with expandable thermal capacities and software logging. ALX-2000-P400 provides approximately 2000W of cooling using a triple fan radiator.

This version includes the RPM-ALX400 and HXM-ALX2000 modules. These are quickly combined during installation, and [individually upgradeable](#) if requirements later change. The front "RPM" contains the pump, reservoir, electronics, and sensors. The rear "HXM" houses the heat exchanger, fans, and flow meter.

A USB port allows control and logging of most features using the [Koolance System Monitor](#) application.

- Cooling capacity: 2000W (6824BTU/hr) with 25° C liquid-

ambient delta @ 5.0LPM

- Temperature in °C/°F with set-point based on: liquid, or one of two optional K-type thermocouples
- Pump: 10 manual levels, up to 5.0LPM (1.3GPM)
- Select only values you want displayed on the front 2-line OLED display (fixed or rotating)
- Show coolant flow rate in LPM/GPM
- Show pump impeller speed in RPM
- Show radiator fan speed in RPM
- Enable audio alarm based on: temperature, flow rate, and/or reservoir coolant level
- Enable relay trigger (NO or NC) based on: temperature, flow rate, and/or reservoir coolant level
- Power input: 12VDC, 97W or higher
- Reservoir capacity: 600ml (20.3 fl oz)
- 1/4 NPT threads on back for fittings

NOTE: Requires 12VDC input power. Koolance offers a separate [power supply](#) for AC wall outlet sources. Inlet/outlet fitting threads on rear of the cooling system are NPT 1/4-inch.

General	
Weight	12.00 lb (5.44 kg)
Fitting Thread	NPT 1/4
Max Pressure Tolerance @ 25° C	1.5kgf/cm2 (21.3psi)
Max Temperature Tolerance	60° C (140° F)
Noise (dBA)	30-63
Cooling Systems	
Cooling Capacity	2000W (6824BTU/hr) @ 25° C liquid-ambient (25° C dT)
Display Type	OLED
Max Flow Rate (10-13mm ID)	5.0LPM (1.3GPM)
Max Power Consumption	97W
Max Static Pressure (10-13mm ID)	0.4kgf/cm2 (6psi)
Power Source	12 VDC

General	
Radiator	Brass/Copper, 3 x 120mm fans
Temperature Sensors	Liquid & Two K-Type Thermocouples (optional)
Temperature Stability	+/-0.5°C

ALX Systems
 $(\Delta T = \text{Inlet Water} - \text{Ambient} = 25^\circ\text{C})$

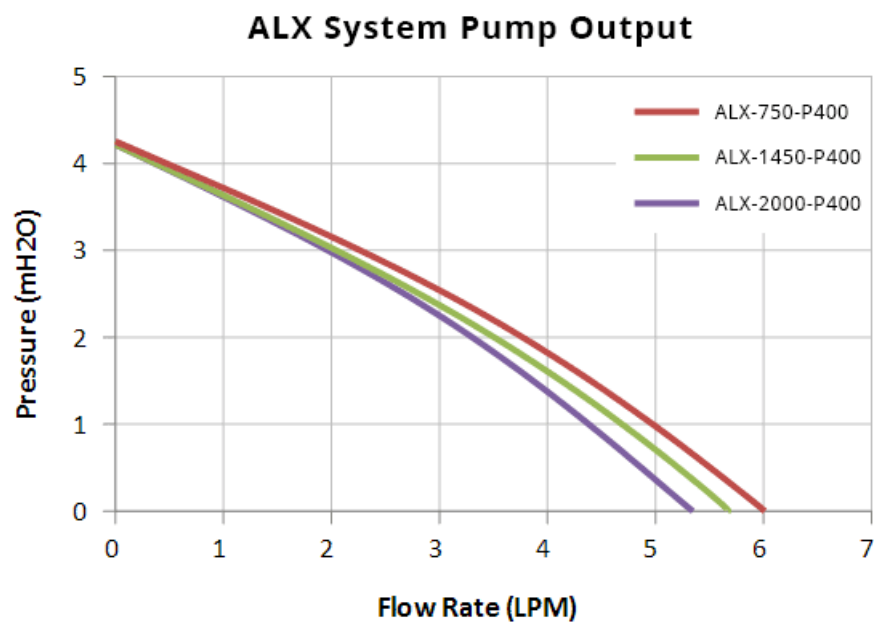
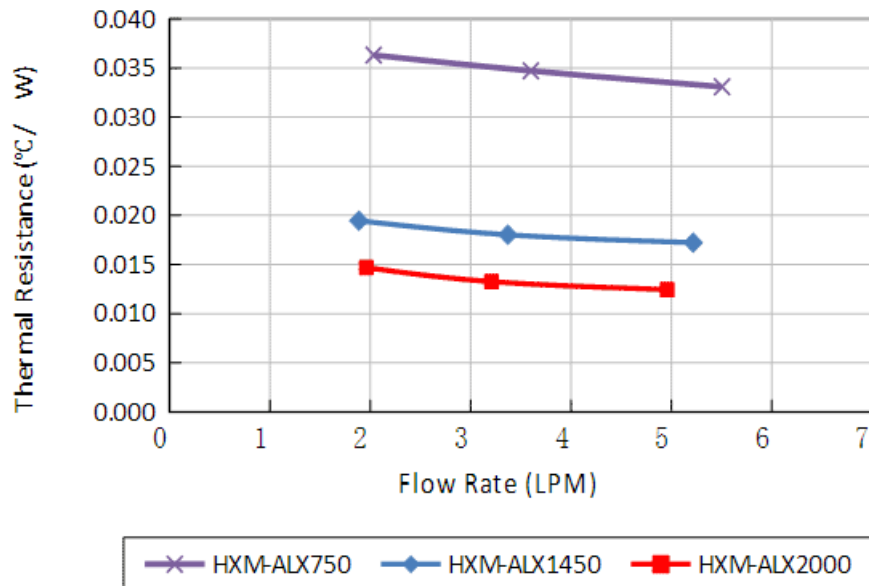

ALX Systems
($\Delta T = \text{Inlet Water} - \text{Ambient} = 25^\circ\text{C}$)

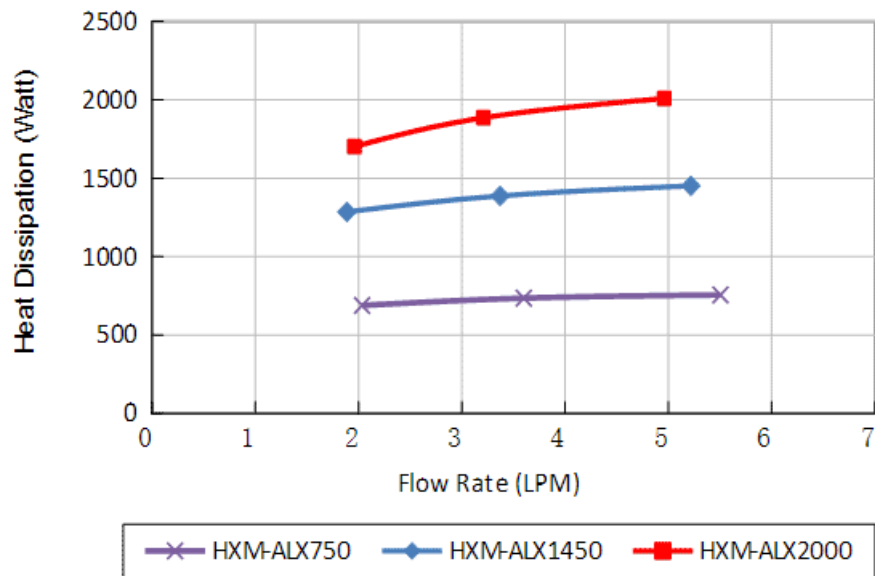

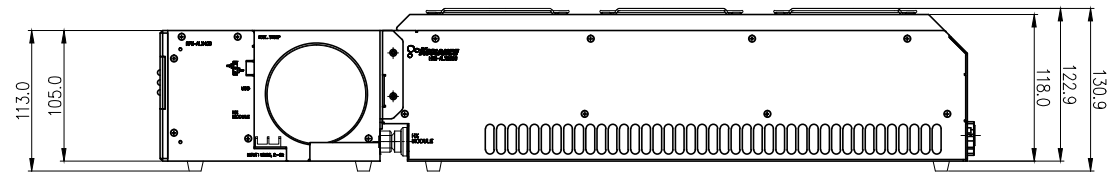
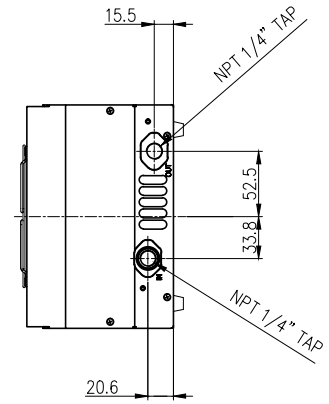
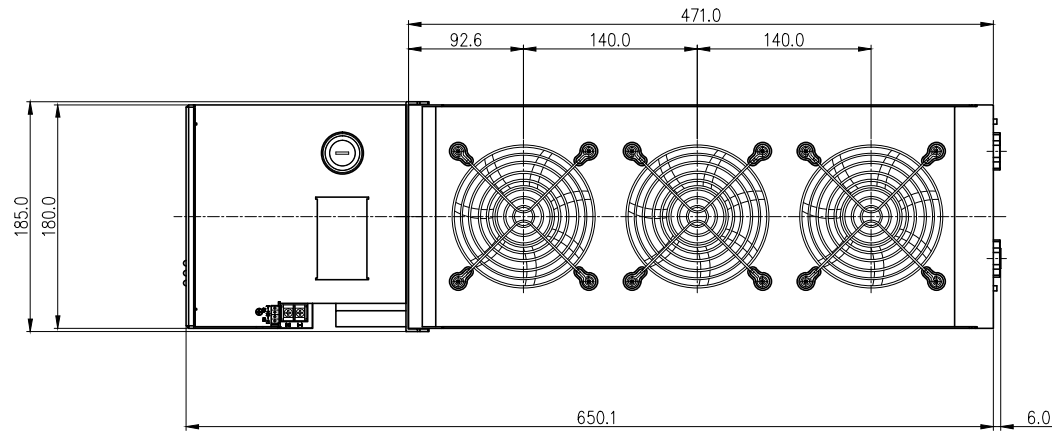
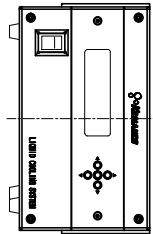
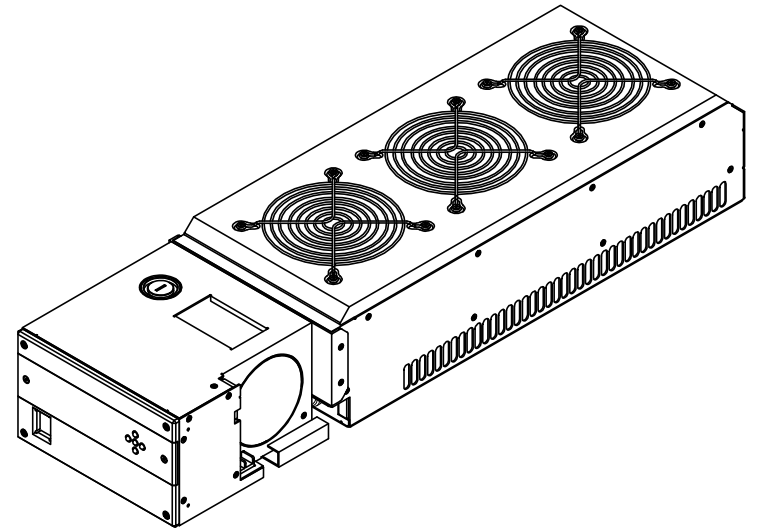
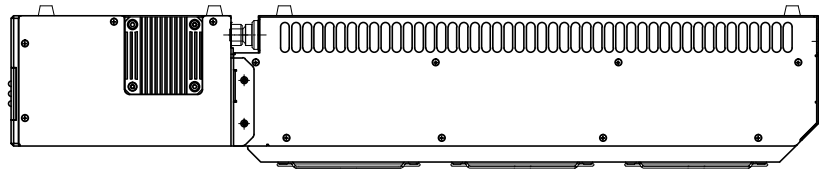

NO.		DISCRIPTION			MATER'L		QUANTITY		REMARKS	
					UNIT	MM	ITEM	ALX-2000-P400		
					SCALE	N/S	TITLE		Ass'y	
DATE		BY	BY	BY	APPRO	BY	3RD ANGLE			
		S.J.LEE					CODE NO.		DWG. NO.	PAGE