



Put heatpipes to shame. The CHC-120-V06 is designed to provide high efficiency liquid cooling for motherboard northbridge or southbridge chipsets (including those below PCI-Express cards). Versatile mounting hardware allows the CHC-120-V06 to cool almost all types of mainboards, or heat sources up to approximately 120W. Materials are solid copper with 24k gold plating and anodized aluminum top.

**Intended Tubing Size**

**ID:** 6mm (1/4")

**OD:** 10mm (3/8")

**Wall:** 2mm (5/64")

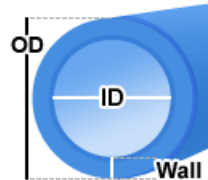

General	
Weight	0.80 lb (0.36 kg)
Materials	Gold-Plated Copper, Nickel-Plated Aluminum

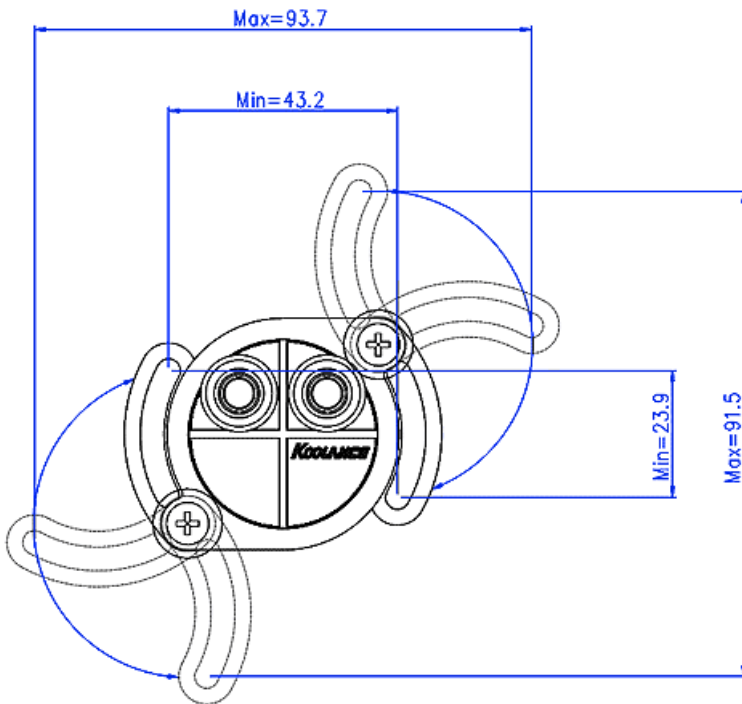

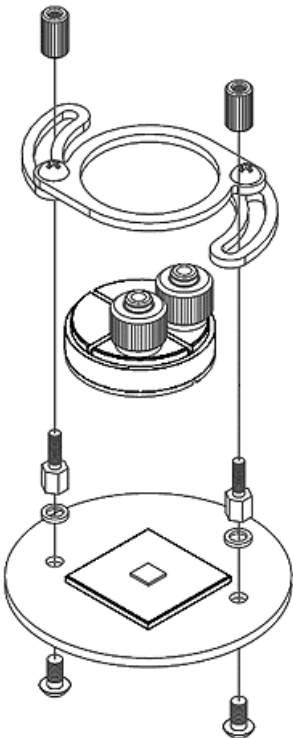
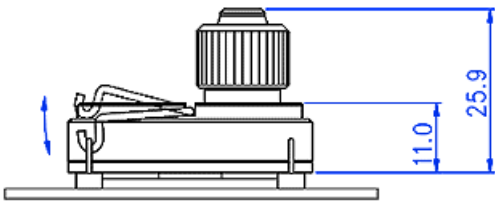
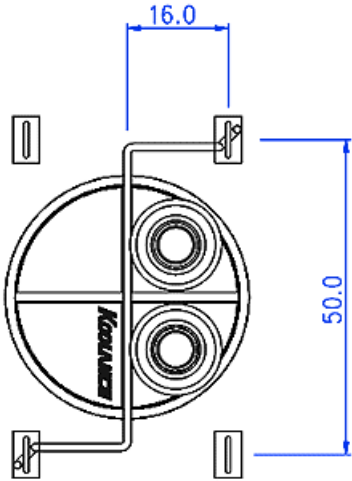
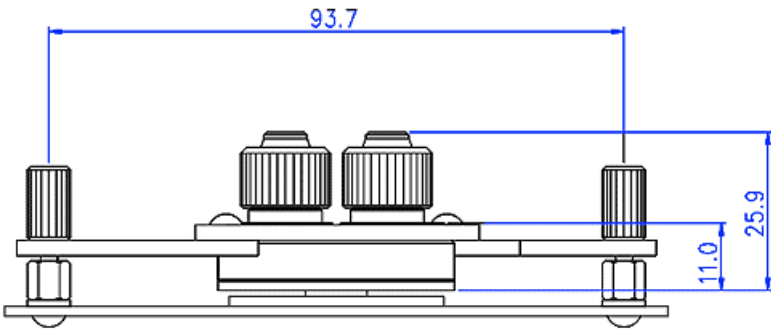

Thermal Resistance vs. Flow Rate

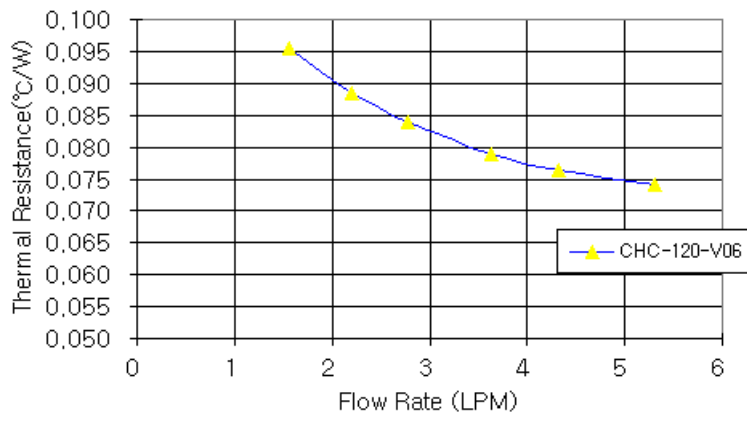

Thermal Resistance vs. Pressure Drop

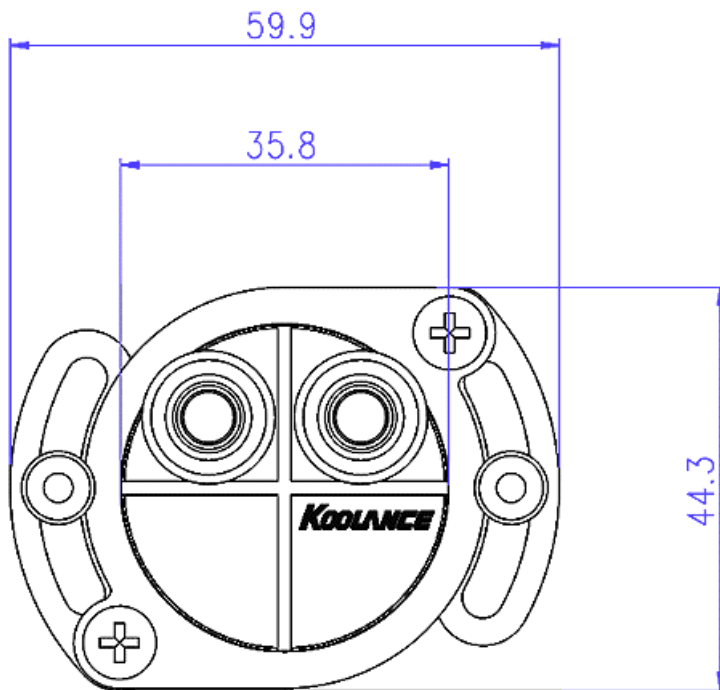
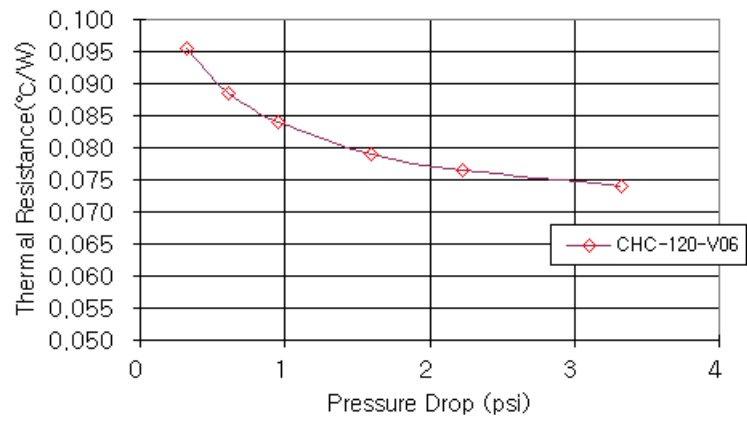

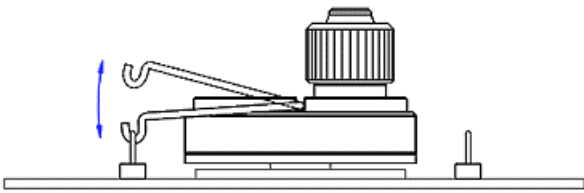
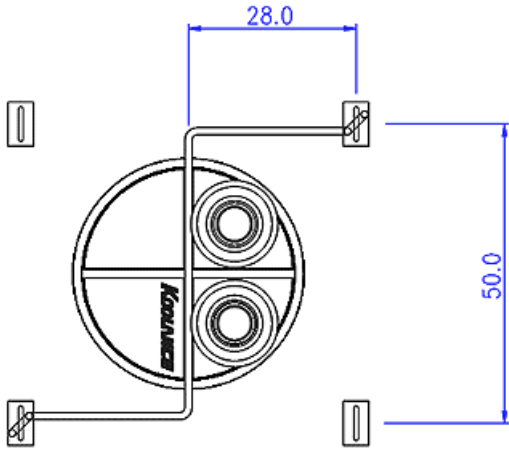
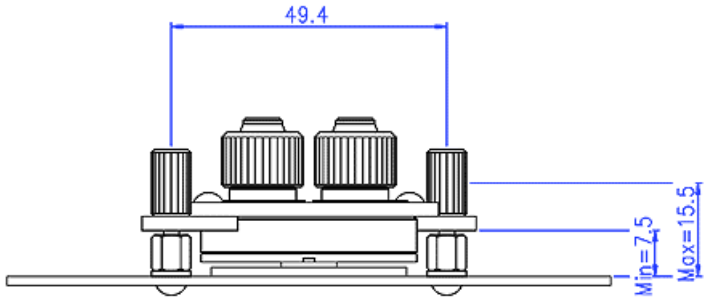

Pressure Drop vs. Flow Rate

