

1 **KOOLANCE** VID-AT1-V06 Installation Guide v 1.0

NOTE: The VID-AT1-V06 is designed for **ATI Radeon-based X800 Pro and X800 XT** cards. The video card should be removed from the chassis in order to install this cooling device.



CAUTION: Removal of the original heat sink may void your manufacturer's hardware warranty. Please consult the manufacturer if unsure, and keep all original parts in case of a return/RMA.



Most ATI Radeon X800 Pro and XT cards are disassembled the same way, although your specific model may vary.



The mounting screws on the bottom side should be removed first. There may be 3 or more of these on your Radeon card.

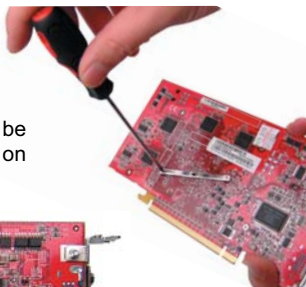
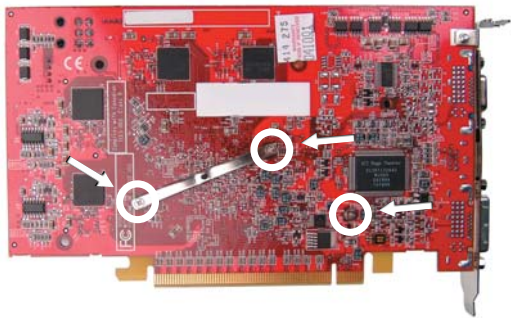

2

Remove the top heat sink and unplug the fan connection. Wipe off the original thermal paste from the video chipset, RAM modules, and heat sink.

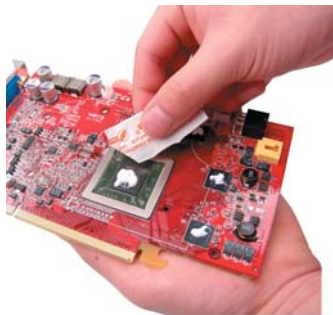

Apply fresh thermal paste to the main chipset, taking care *only to coat the raised center core*. The outer portion of the chipset and metal frame do not require thermal compound.

Apply a small amount of thermal paste to all 4 memory chips on top of the card. Memory on the card's rear side will not need thermal paste for the VID-AT1-V06.

Spread the thermal compound evenly to cover each chip using the paste packet, or a piece of thick paper (such as a business card).



3

Open the VID-AT1-V06 enclosure and remove the protective film from the bottom of the chipset cooler.

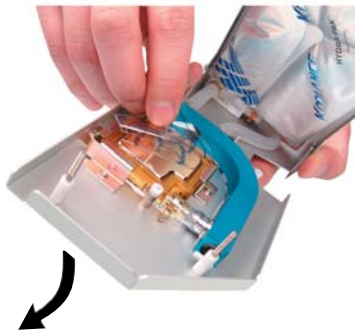

Place the video card into the cooling enclosure. There are 2 long screws on the enclosure which must be inserted through the card.

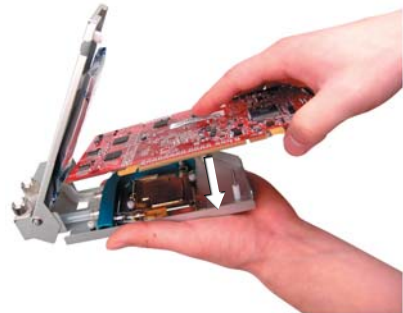

4 small mounting screws are included with the VID-AT1-V06. Thread an insulating washer onto each of these.



From the card's back side, insert and tighten each of the 4 screws into the remaining mounting holes with a screw driver.

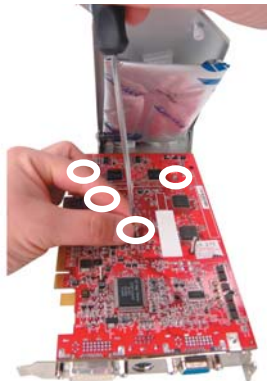

4



Fold the enclosure closed. The long screws should fit through both holes in the VID-AT1-V06 back plate.

Finally, hand-tighten a nut firmly to both primary screws.

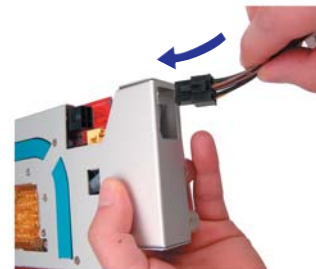
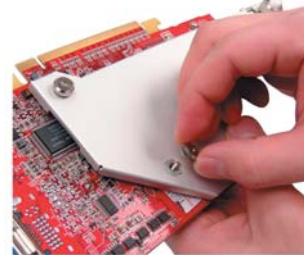

When installing your Radeon card, the power supply connection can be inserted through the back of the VID-AT1-V06.

NOTE: Video card RAM chips are not perfectly flat with one another. To make sure your liquid cooler is making the best contact possible for your card, remove the cooler and examine the distribution of thermal paste.

A missing or inadequate "spot" might be corrected by further tightening a mounting nut or screw (gradually), or applying more thermal paste to the chip.

