

Radiator, 2x120mm Fans, 54mm Thick, 30-FPI
Copper



HX-240XC is an extra thick (54mm, 2.1in) copper core radiator with a fin density of 30 FPI (fins per inch). It offers greatest performance when sandwiched between multiple high speed 120mm fans. It has a dual pass coolant design, and is G 1/4 BSPP (parallel) thread for hose fittings. 30mm (1.18") long mounting screws are included for 25mm thick fans on one side only (see Koolance [radiator screw packs](#) for additional options).

General	
Weight	2.60 lb (1.18 kg)
Fitting Thread	G 1/4 BSPP
Materials	Brass/Copper
Max Pressure @ 25 °C	2kgf/cm2 (28.5psi)
Max Temperature	150 °C (302 °F)
Radiators	
Fan Capacity	2 x 120mm
Fins Per Inch (FPI)	30

6mm ID Tubing

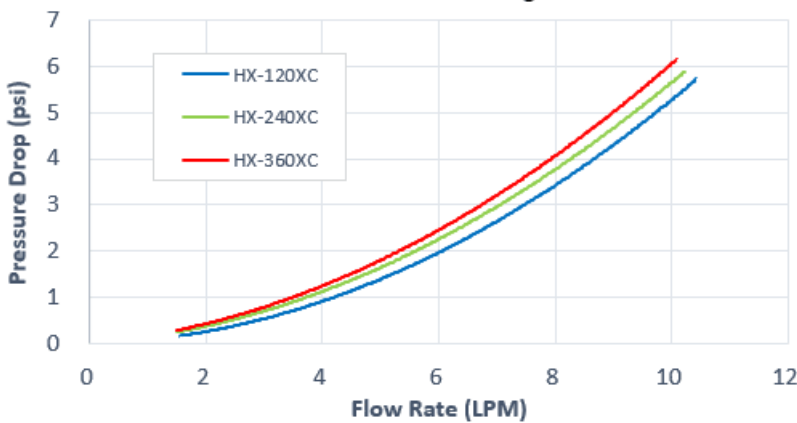

Koolance HX-240XC
 $(\Delta T = \text{Inlet Water} - \text{Ambient})$

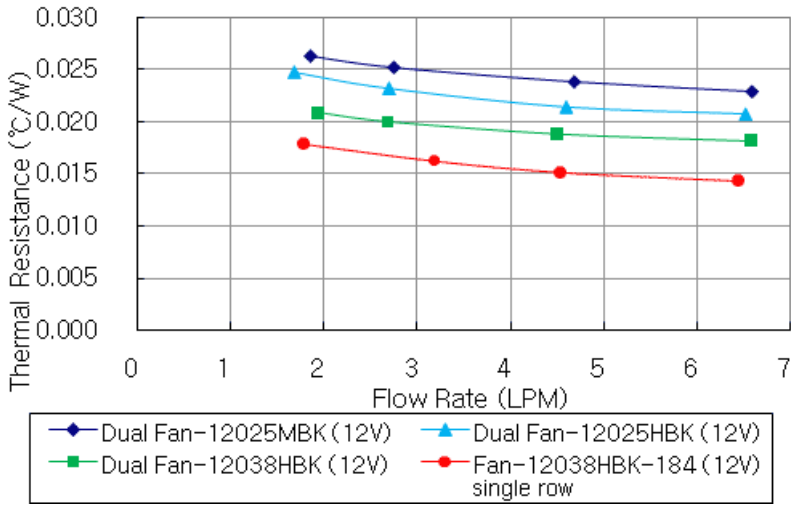

Koolance HX-240XC
 $(\Delta T = \text{Inlet Water} - \text{Ambient} = 25^\circ\text{C})$

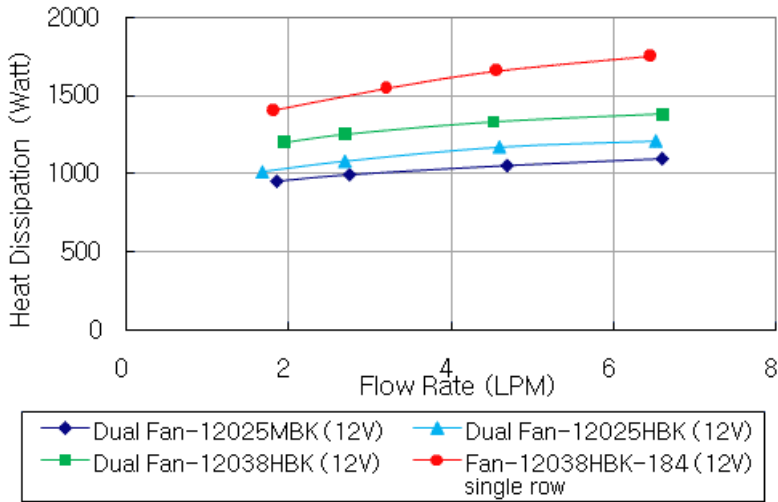

Koolance HX-240XC
 $(\Delta T = \text{Inlet Water} - \text{Ambient} = 15^\circ\text{C})$

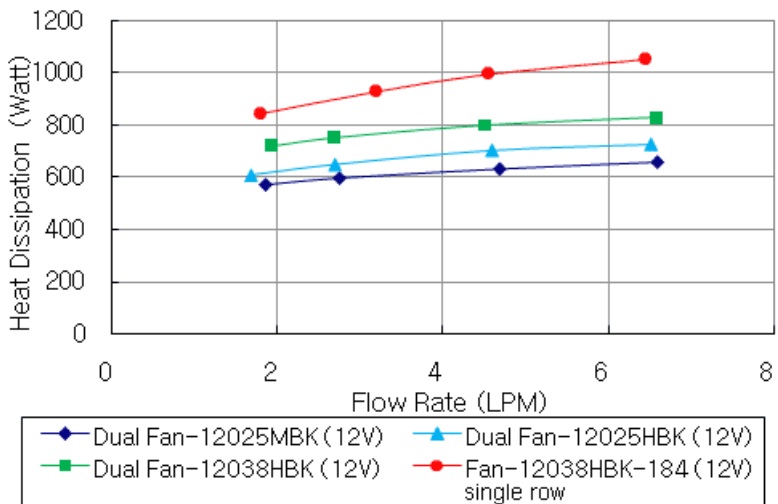

10-13mm ID Tubing

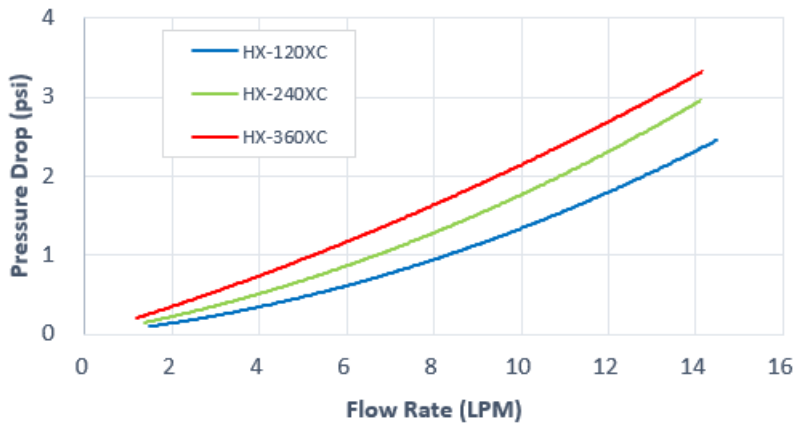

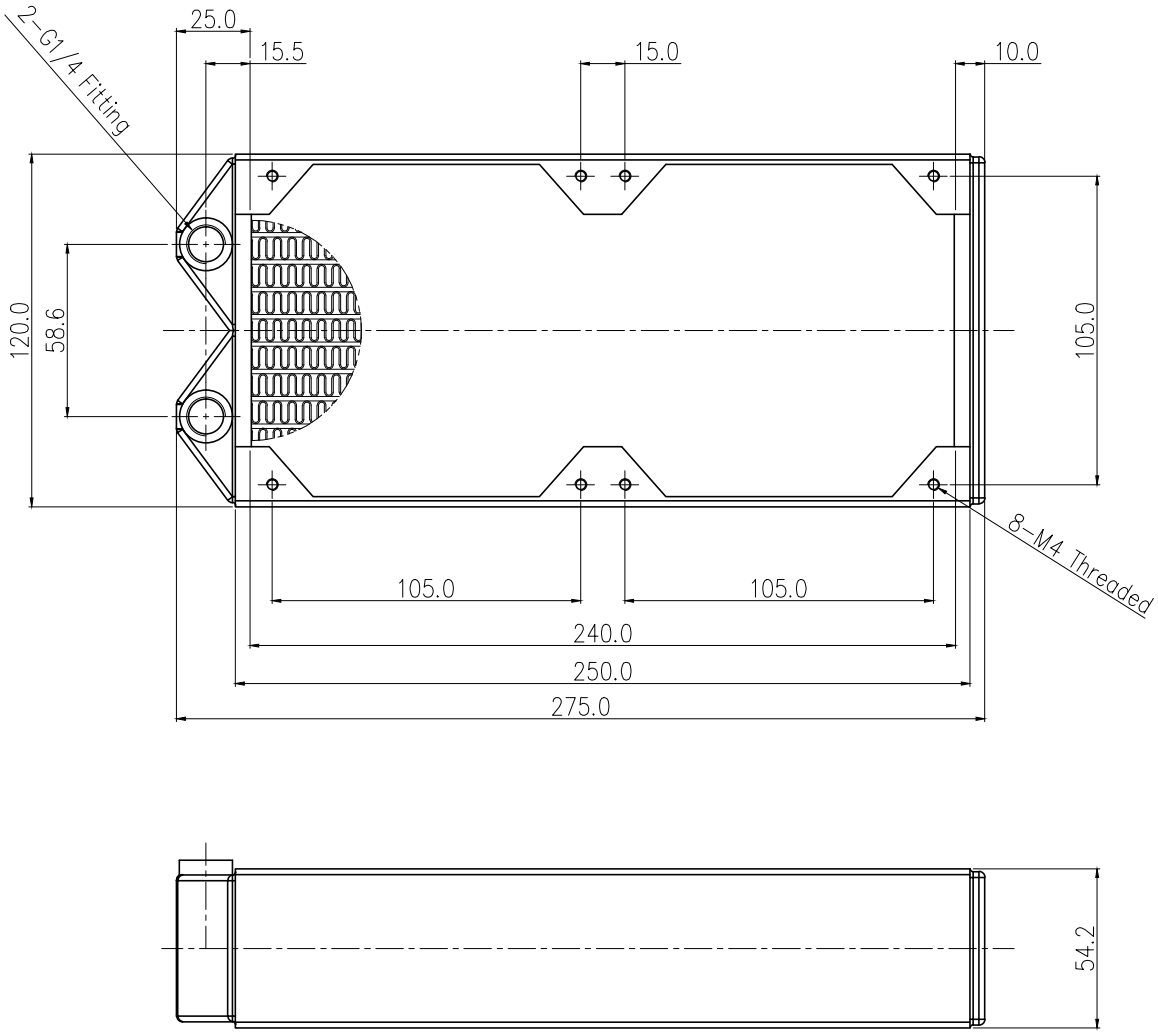

REV	DATE	CONTENTS	REVD BY	CHKD BY	APPD BY
REVISION					

NO.	DESCRIPTION	MATER'L	QUANTITY	REMARKS
		UNIT	MM	ITEM HX-240XC
		SCALE	N/S	TITLE
DATE	BY	BY	BY	BY
	S.J.LEE			
		3RD ANGLE		
		CODE NO.		
			DWG. NO.	PAGE