

HXP-135 Compact Plate Heat Exchanger

Plate heat exchangers provide highly efficient heat transfer between two liquids without allowing them to mix. They are ideal for managing coolant pressure differences, and for isolating sensitive equipment from potentially damaging liquids. Koolance plate heat exchangers are among the most compact and cost effective available.

The HXP-135 is a proprietary Koolance design, and possibly the smallest heat exchanger of its kind. It is made of copper-brazed stainless steel and plated externally in nickel. A detachable heavy steel mounting bracket and screws are included. G 1/4 BSPP threading.

- Heat Transfer: 2.7 kW (9,200 BTU/hr) (@5LPM, Delta between inlets = 20 °C)
- Design Pressure: 10kgf/cm² (140 PSIG)
- Design Temperature: -40 °C (-40 °F) min, 130 °C (270 °F) max
- Number of Plates: 15
- Channel Plate Material: SUS304 Stainless Steel
- Brazing Material: Copper

General	
Weight	1.00 lb (0.45 kg)
Fitting Thread	G 1/4 BSPP
Max Pressure Tolerance @ 25 °C	10kgf/cm ² (142.2psi)
Max Temperature Tolerance	130 °C (270 °F)
Wetted Materials	SUS304, Copper, Nickel

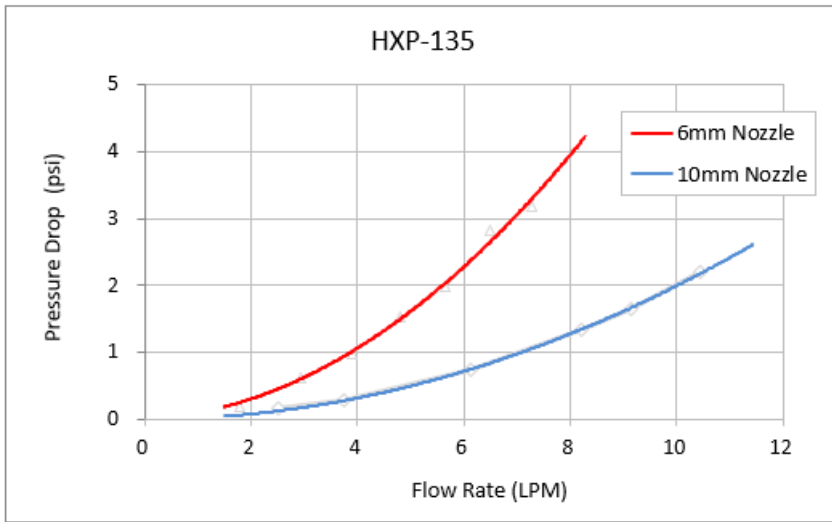

$\Delta T = 20^{\circ}\text{C}$

Flow	Cold Flow				
Flow Rate	2LPM	4LPM	6LPM	8LPM	
Hot Flow	2LPM	1140	1480	1660	1800
	4LPM	1480	1820	2200	2500
	6LPM	1660	2200	2520	2900
	8LPM	1800	2500	2900	3080

$\Delta T = 10^{\circ}\text{C}$

Flow	Cold Flow				
Flow Rate	2LPM	4LPM	6LPM	8LPM	
Hot Flow	2LPM	570	740	830	900
	4LPM	740	910	1100	1250
	6LPM	830	1100	1260	1450
	8LPM	900	1250	1450	1540

HXP-135

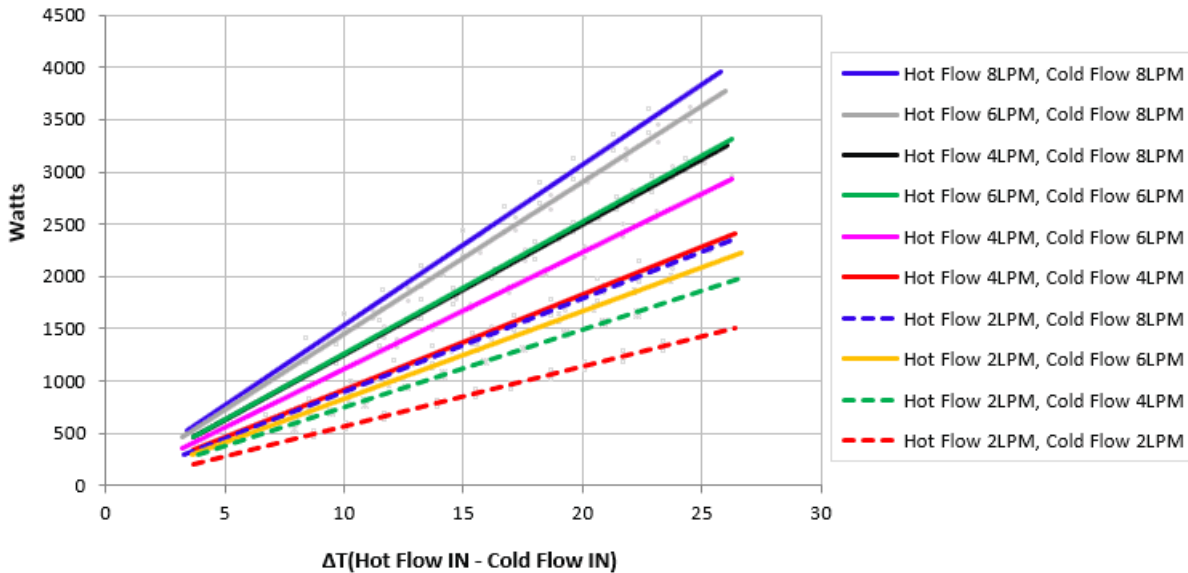

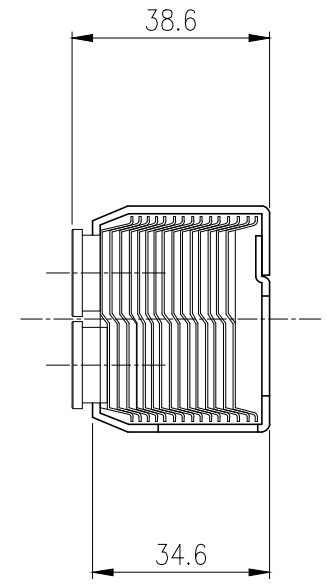
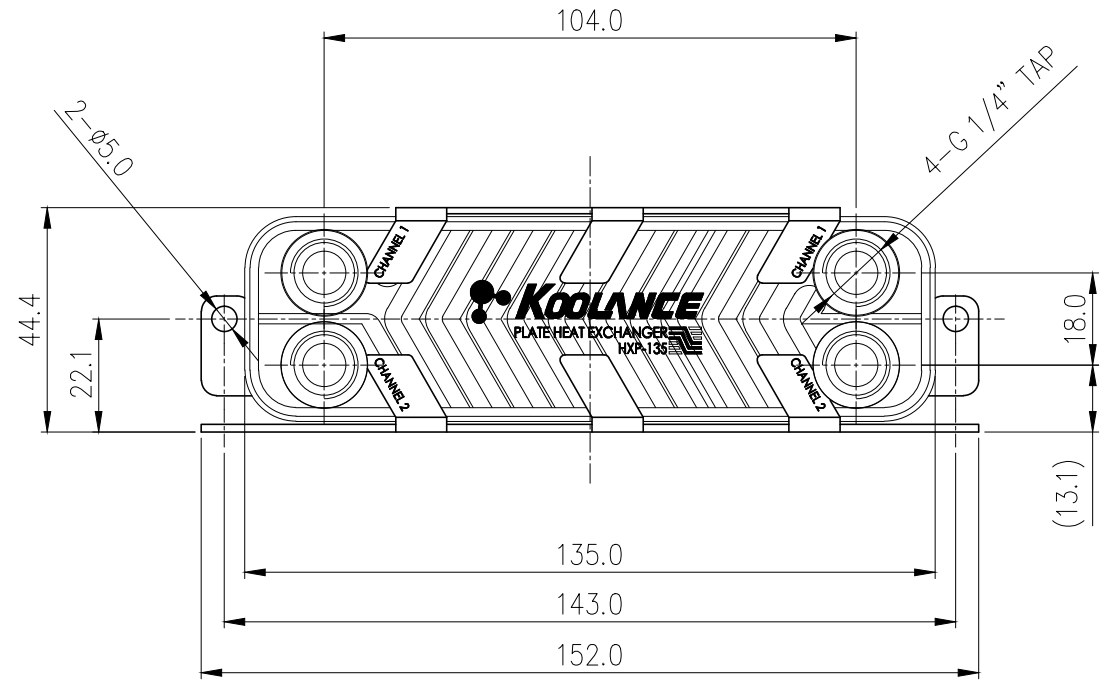
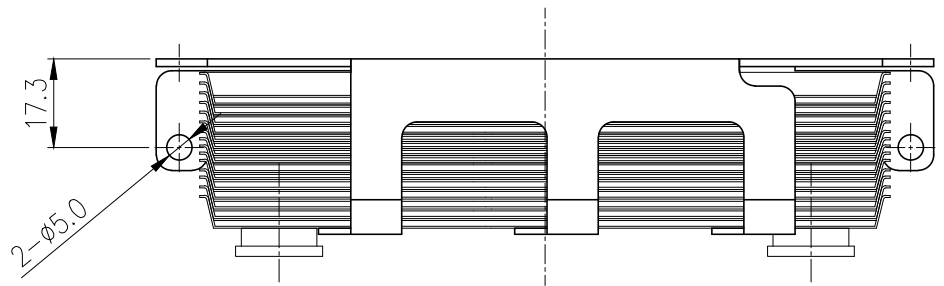

NO.	DESCRIPTION	MATER'L		QUANTITY	REMARKS
	KOOLANCE	UNIT	MM	APPAR	HXP-135
		SCALE	N/S	TITLE	
DATE	BY	BY	BY	APPRO	BY
04/11/2017	S.J.LEE				
				3RD ANGLE	Ass'y
				CODE NO.	DWG. NO.