

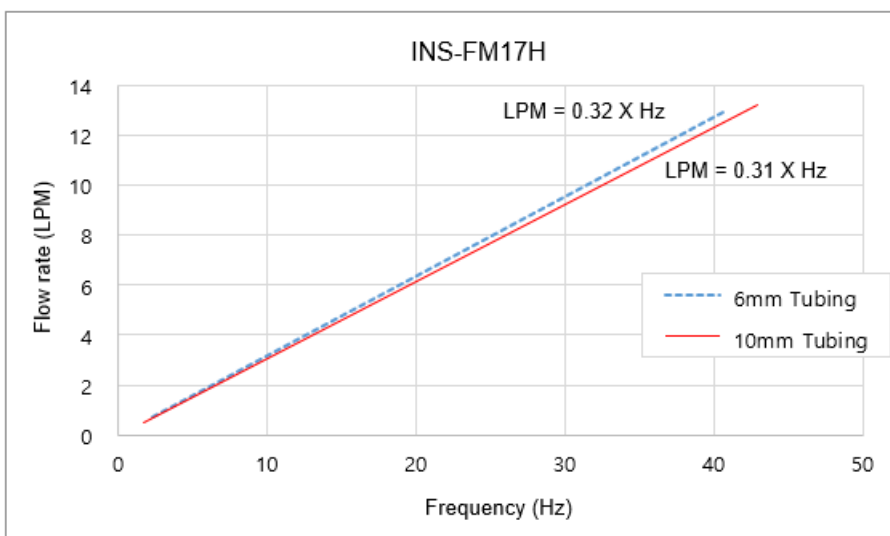

Koolance's inline flow meters provide electronic indication of real-time coolant flow rate. This model uses a hall effect sensor to detect impeller rotation speed. G 1/4 BSPP fitting threads, and primary materials are nickel-plated brass and acrylic. Approximate read range is 1.0-20 LPM (15.6-317 GPH). The flow meter accepts 4.5-24VDC, and a maximum current of 10mA. Wire length is about 28" (70cm).

Flow Meters	
Accuracy (Approx.)	+/-5%
Flow Rate Range	1.0-20 LPM (15.6-317 GPH)
General	
Weight	0.13 lb (0.06 kg)
Fitting Thread	G 1/4 BSPP
Max Pressure Tolerance @ 25° C	2kgf/cm2 (28.5psi)
Max Temperature Tolerance	70° C (158° F)
Min Storage Temperature (*No Freezing)	0° C (32° F)
Wetted Materials	Nickel-Plated Brass, PTFE, PMMA Acrylic, Stainless Steel, POM Acetal, PBT, SmCo5

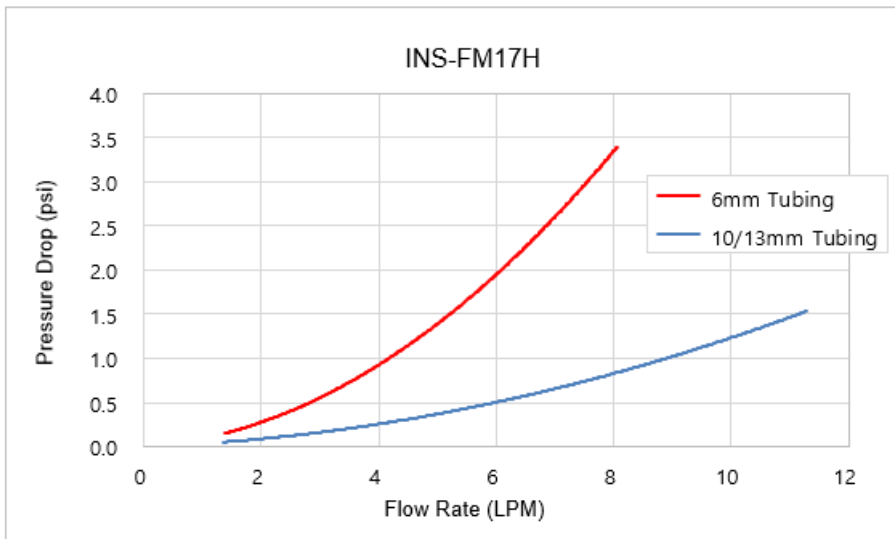



< 3pin CONNECTOR >

- Housing : JST XHP-3 (or Equivalent)
- Terminal : JST SXH-001T-P0.6 (or Equivalent)

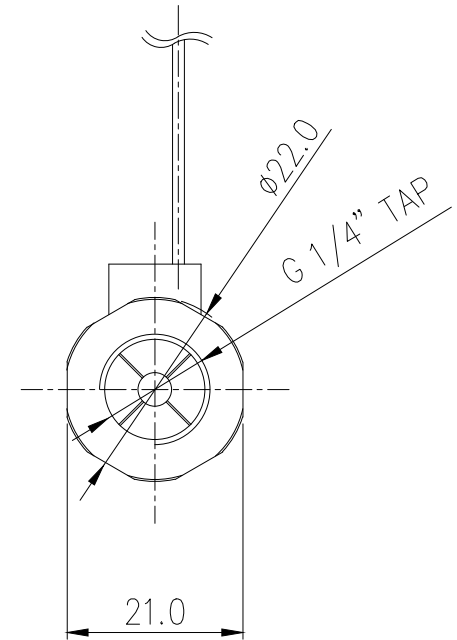
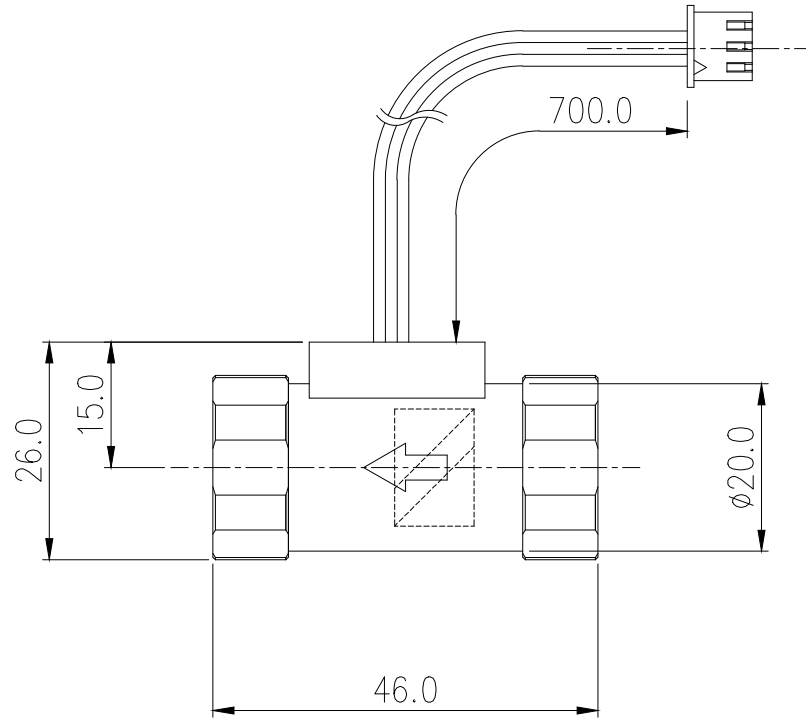
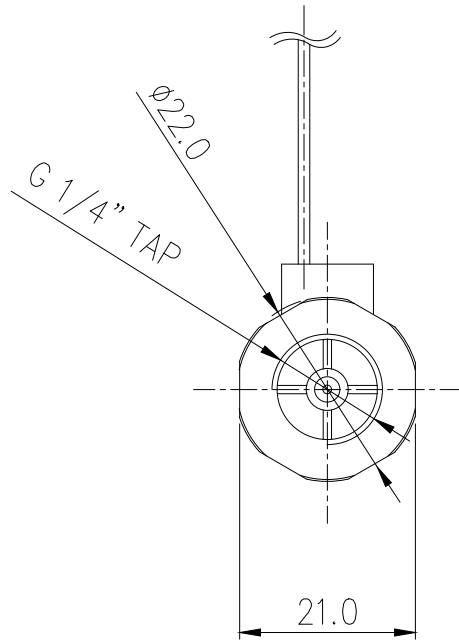
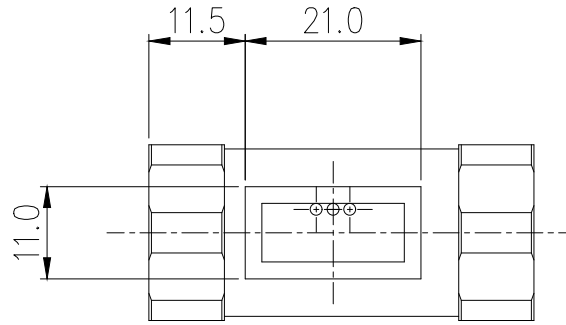
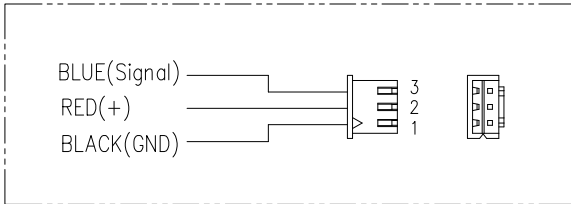

NO.	DESCRIPTION				MATER'L		QUANTITY	REMARKS
					UNIT	MM	APPAR	INS-FM17H
					SCALE	N/S	TITLE	
DATE	BY	BY	BY	APPRO BY	3RD ANGLE		Ass'y	
JUL.28.2023	S.J.LEE				CODE NO.	DWG. NO.		