

QD3 Female Quick Disconnect No-Spill Coupling, Panel Barb for ID 13mm (1/2in)



Koolance patented quick disconnect no-spill coupling with automatic shutoff. 13mm (1/2in) ID female panel-mountable hose barb with clamp for 16mm OD (5/8in). It will only fit a Koolance QD3 male quick disconnect.

After pulling the ring on the female QDC side, the quick-disconnect fittings will separate. Liquid on both sides will be automatically obstructed with approximately 0.2ml freed. Coolant volume lost upon disconnection will rise with internal pressure higher than 0.5kgf/cm² (7psi).

General	
Weight	0.21 lb (0.10 kg)
Max No-Spill Pressure	0.5kgf/cm ² (7psi)
Max Pressure Tolerance @ 25° C	8kgf/cm ² (113.8psi)
Max Temperature Tolerance	80° C (176° F)
Min Pressure Tolerance @ 25° C	-1.0kgf/cm ² (-14psi)
Min Storage Temperature (*No Freezing)	-20° C (-4° F)
Seal Material	EPDM (Water/Glycol Liquids)
Wetted Materials	Brass, Nickel Plating, Stainless Steel, EPDM



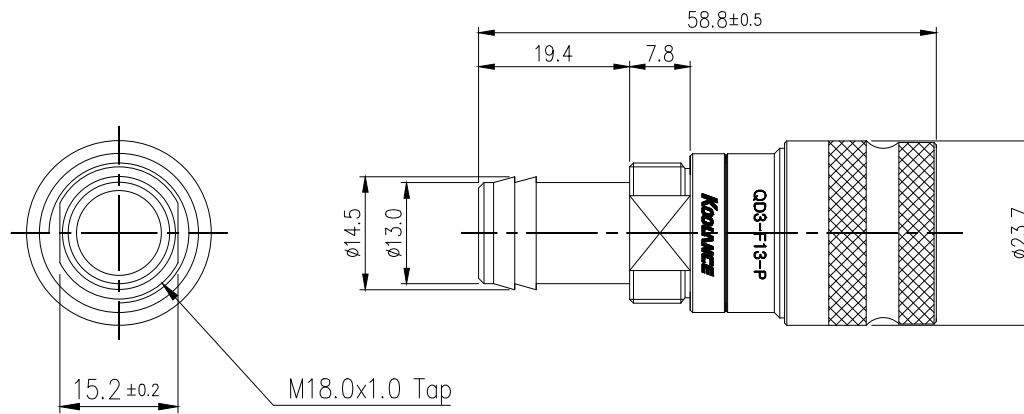
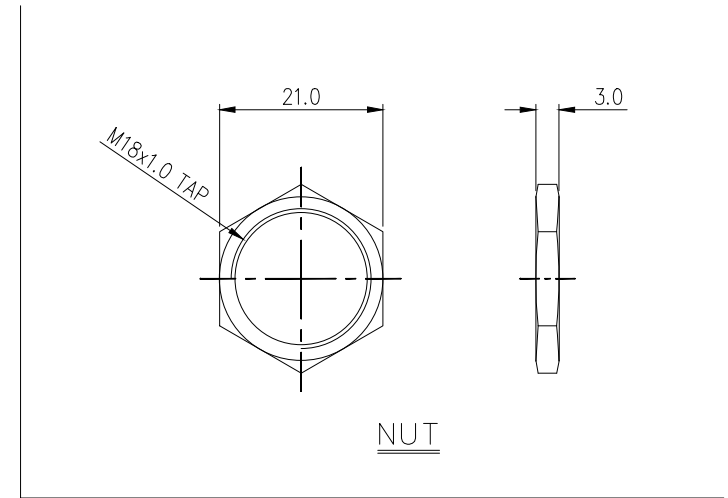

REV	DATE	CONTENTS	REVD BY	CHKD BY	APPD BY
REVISION					

NO.	DISCRIPTION			MATER'L		QUANTITY	REMARKS
	KOOLANCE			UNIT	MM	ITEM	QD3
				SCALE	N/S	TITLE	QD3-F13-P
DATE	BY	BY	BY	ANGULAR DIMENSIONS		3RD ANGLE	
				XX°	XX.X°	±0.5°	±0.1°
				SURFACE	SURFACE	CODE NO.	DWG. NO.
				ROUGHNESS	.63	1.6	PAGE