

**QD3 Female Quick Disconnect No-Spill  
Coupling, Compression for 13mm x 19mm  
(1/2in x 3/4in) \*Black\***



Koolance patented quick disconnect no-spill coupling with automatic shutoff. 13mm (1/2in) ID, 19mm (3/4in) OD female straight connection with compression fitting. It will only fit a Koolance QD3 male quick disconnect.

After pulling the ring on the female QDC side, the quick-disconnect fittings will separate. Liquid on both sides will be automatically obstructed with only 0.5-1mL freed with approximately 0.2ml freed. Coolant volume lost upon disconnection will rise with internal pressure higher than 0.5kgf/cm<sup>2</sup> (7psi).

General	
Weight	0.23 lb (0.10 kg)
Max No-Spill Pressure	0.5kgf/cm <sup>2</sup> (7psi)
Max Pressure Tolerance @ 25 °C	8kgf/cm <sup>2</sup> (113.8psi)
Max Temperature Tolerance	80 °C (176 °F)
Min Pressure Tolerance @ 25 °C	-1.0kgf/cm <sup>2</sup> (-14psi)
Min Storage Temperature (*No Freezing)	-20°C (-4°F)
Seal Material	EPDM (Water/Glycol Liquids)
Wetted Materials	Brass, Chrome Plating, Stainless Steel, EPDM

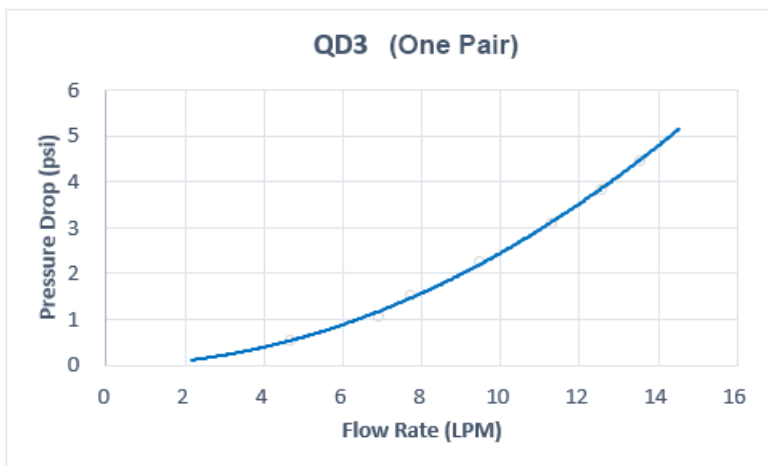

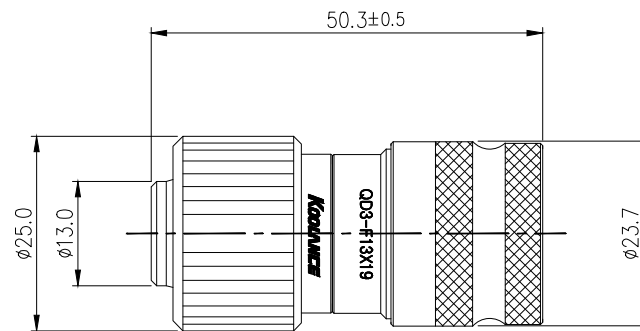

REV	DATE	CONTENTS	REVD BY	CHKD BY	APPD BY	
REVISION						

NO.		DISCRPTION					MATER'L		QUANTITY	REMARKS
<b>KOOLANCE INC.</b>		DECIMAL PLACES		INCHES	MILLIMETRES	UNIT	MM	ITEM	QD3	
		.XXX	±.005	±0.1	SCALE	N/S	TITLE	QD3-F13X19		
		.XX	±.010	±0.3						
		.	±.020	±0.5						
		ANGULAR DIMENSIONS					3RD ANGLE			
DATE	BY	BY	BY	APPRO	BY	XX° XX'X"	±0.5° ±0.1°		CODE NO.	DWG. NO.
						SURFACE ROUGHNESS	SURFACE .63	SURFACE 1.6		PAGE