

**QD3 Male Quick Disconnect No-Spill Coupling,
Compression for 13mm x 19mm (1/2in x 3/4in)
*Black***



Koolance patented quick disconnect no-spill coupling with automatic shutoff. 13mm (1/2in) ID, 19mm (3/4in) OD male straight connection with compression fitting. It will only fit a Koolance QD3 female quick disconnect.

After pulling the ring on the female QDC side, the quick-disconnect no-spill fittings will separate. Liquid on both sides will be automatically obstructed with approximately 0.2ml freed. Coolant volume lost upon disconnection will rise with internal pressure higher than 0.5kgf/cm² (7psi).

General	
Weight	0.16 lb (0.07 kg)
Max No-Spill Pressure	0.5kgf/cm ² (7psi)
Max Pressure Tolerance @ 25 °C	8kgf/cm ² (113.8psi)
Max Temperature Tolerance	80 °C (176 °F)
Min Pressure Tolerance @ 25 °C	-1.0kgf/cm ² (-14psi)
Min Storage Temperature (*No Freezing)	-20°C (-4°F)
Seal Material	EPDM (Water/Glycol Liquids)
Wetted Materials	Brass, Chrome Plating, Stainless Steel, EPDM

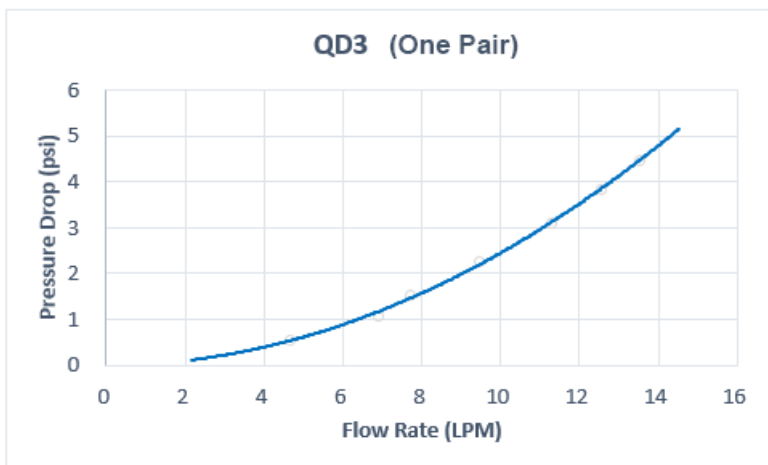

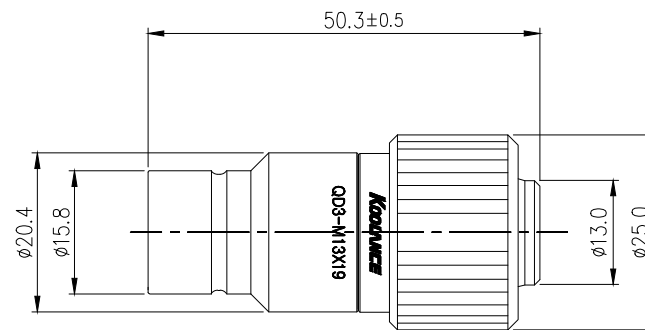

REV	DATE	CONTENTS	REVD BY	CHKD BY	APPD BY
REVISION					

NO.		DISCRIPTION				MATER'L		QUANTITY	REMARKS
		Koolance				UNIT	MM	ITEM	QD3
						SCALE	N/S	TITLE	QD3-M13X19
DATE		BY	BY	BY	APPRO BY	ANGULAR DIMENSIONS		3RD ANGLE	
						XX"	±0.5"	CODE NO.	DWG. NO.
						XX.X"	±0.1"		PAGE
						SURFACE ROUGHNESS	SURFACE .63 SURFACE 1.6		