

QD3 Male Quick Disconnect No-Spill Coupling, Panel Female Threaded G 1/4 BSPP



Koolance patented quick disconnect no-spill coupling with automatic shutoff. G 1/4 BSPP (parallel) thread female with panel-mount opposite a male "QD3" quick-disconnect. It will only fit a Koolance QD3 female quick disconnect.

After pulling the ring on the female QDC side, the quick-disconnect fittings will separate. Liquid on both sides will be automatically obstructed with approximately 0.2ml freed. Coolant volume lost upon disconnection will rise with internal pressure higher than 0.5kgf/cm² (7psi). Fittings are nickel-plated brass, EPDM o-rings.

General	
Weight	0.11 lb (0.05 kg)
Max No-Spill Pressure	0.5kgf/cm ² (7psi)
Max Pressure Tolerance @ 25° C	8kgf/cm ² (113.8psi)
Max Temperature Tolerance	80° C (176° F)
Min Pressure Tolerance @ 25° C	-1.0kgf/cm ² (-14psi)
Min Storage Temperature (*No Freezing)	-20° C (-4° F)
Seal Material	EPDM (Water/Glycol Liquids)
Wetted Materials	Brass, Nickel Plating, Stainless Steel, EPDM

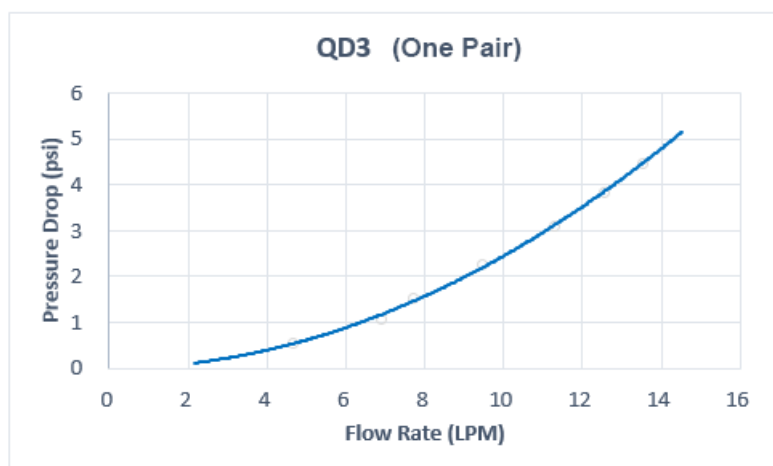

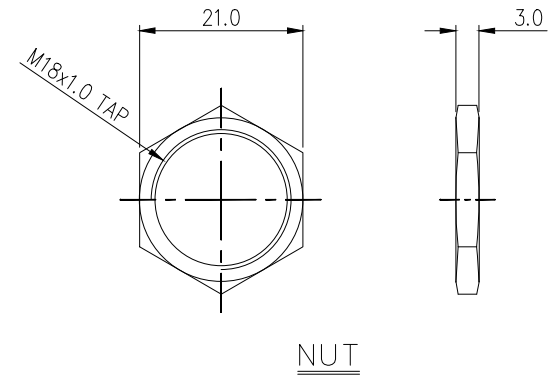
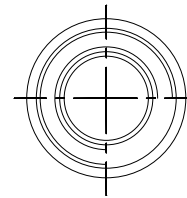
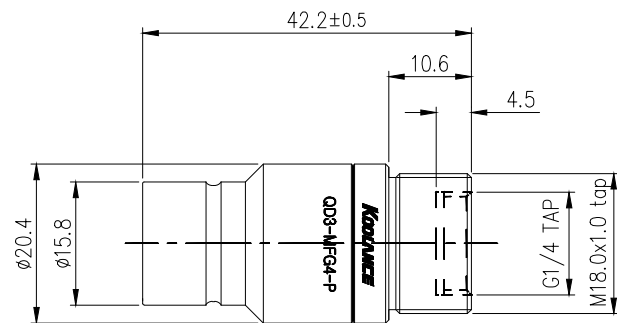

REV	DATE	CONTENTS	REVD BY	CHKD BY	APPD BY
REVISION					

NO.	DISCRIPTION					MATER'L		QUANTITY		REMARKS	
Koolance						UNIT	MM	ITEM	QD3		
						SCALE	N/S	TITLE	QD3-MFG4-P		
DATE	BY	BY	BY	APPRO	BY	3RD ANGLE		DWG. NO.		PAGE	
ANGULAR DIMENSIONS											
XX" XX"		±0.5" ±0.1"									
						SURFACE ROUGHNESS	SURFACE	SURFACE			
						.63	1.6				